

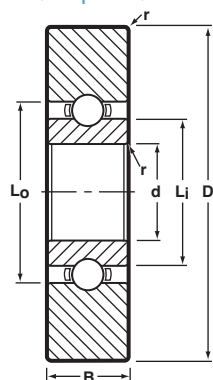

Modified Dimension, Radial, Open, Unflanged and Flanged



Unflanged Ribbon Cage



Flanged Crown Cage

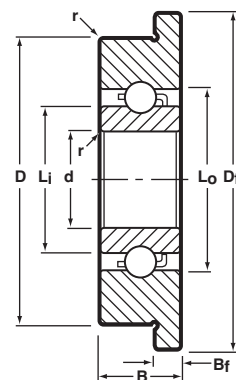

BASIC P/N	CAGE TYPE *	BORE d		O.D. D		WIDTH B		FLANGE DIA. Df	FLANGE WIDTH Bf	LAND DIAMETER (REFERENCE)		FILLET RADIUS r	BALL COMPLEMENT		LOAD RATINGS** LB.	
		INCH	(mm) ∅	INCH	(mm) ∅	INCH	(mm) ∅			Lj	Lo		NO. Z	SIZE Db	DYN. C	STATIC Co
SSRIF-2 ▲	H	.0400	1.016	.1250	3.175	.0469	1.191	.171	.013	.064	.101	.003	5	.025	5	3
SSRIF-3332SD503 ▲	R	.0781	1.984	.1875	4.763	.0625	1.588	.226	.018	.118	.161	.003	8	1/32	35	14
SSRIF-418SD513 ▲	R	.0781	1.984	.2500	6.350	.0625	1.588	.296	.018	.161	.216	.003	8	.0394	53	22
SSRI-3332N1MC*	KC/M5	.0925	2.350	.1875	4.763	.0625	1.588	—	—	.118	.161	.003	7	1/32	19	6
SSRI-3332A02	H	.0937	2.380	.3125	7.938	.0625	1.588	—	—	.118	.161	.003	7	1/32	19	6
SSRI-3332A02	R	.0937	2.380	.3125	7.938	.0625	1.588	—	—	.118	.161	.003	8	1/32	21	8
SSRI-418A62N	H	.0937	2.380	.4250	10.795	.0937	2.380	—	—	.161	.216	.003	7	.0394	30	11
SSRI-418A62N	R	.0937	2.380	.4250	10.795	.0937	2.380	—	—	.161	.216	.003	8	.0394	33	12
SSRI-5A62	H	.0937	2.380	.4500	11.430	.1094	2.779	—	—	.173	.270	.003	6	1/16	60	22
SSRI-418N1	H	.0947	2.405	.2500	6.350	.0937	2.380	—	—	.161	.216	.003	7	.0394	30	11
SSRI-418N1	R	.0947	2.405	.2500	6.350	.0937	2.380	—	—	.161	.216	.003	8	.0394	33	12
SSRI-3 1/2 18	R/H	.1250	3.175	.2188	5.558	.0937	2.380	—	—	.150	.193	.005	7	1/32	21	7
SSRI-418Y02	H	.1250	3.175	.2500	6.350	.0625	1.588	—	—	.171	.214	.003	9	1/32	23	9
SSRIFW-518 ▲	R/H	.1250	3.175	.3125	7.938	.1094	2.779	.359	.029	.173	.270	.003	6	1/16	60	22
SSRIF-518Y04CV52	R	.1250	3.175	.3125	7.938	.0937	2.380	.359	.023	.173	.271	.003	6	1/16	60	22
SSRI-418A0223	H	.1250	3.175	.3750	9.525	.0650	1.651	—	—	.171	.214	.003	9	1/32	23	9
SSRIF-618SD504 ▲	H	.1250	3.175	.3750	9.525	.1094	2.779	.412	.023	.173	.270	.005	6	1/16	60	22
SSRIF-518A91	R/H	.1250	3.175	.4100	10.414	.1094	2.779	.438	.023	.173	.270	.003	6	1/16	60	22
SSRI-518A62	H	.1250	3.175	.4500	11.430	.1094	2.779	—	—	.173	.270	.003	6	1/16	60	22
SSRI-518A03	R/H	.1250	3.175	.5000	12.700	.1094	2.779	—	—	.173	.270	.003	6	1/16	60	22
SSRIF-5532A91 ▲	H	.1562	3.967	.4100	10.414	.1094	2.779	.438	.023	.221	.279	.003	7	3/64	41	15
SSRIF-5532A91 ▲	R	.1562	3.967	.4100	10.414	.1094	2.779	.438	.023	.221	.279	.003	8	3/64	45	17
SSR-3X8LLW20	R	.1875	4.763	.5000	12.700	.3125	7.938	—	—	.243	.434	.012	7	3/32	140	59
SSRI-614Y05	H	.2500	6.350	.3750	9.525	.1094	2.779	—	—	.285	.341	.003	13	.0394	43	21
SSRIF-814X3 ▲	R	.2500	6.350	.5000	12.700	.1250	3.175	.547	.023	.315	.433	.005	8	5/64	114	48
SSRI-1038Y06	R	.3750	9.525	.6250	15.875	.1250	3.175	—	—	.458	.541	.010	12	1/16	95	49
SSRIF-1438SD503 ▲	R	.3750	9.525	.8750	22.225	.2188	5.558	.969	.062	.521	.741	.016	7	5/32	569	273

Notes:

- Inch to metric conversion—see page 68.
  - Basic part numbers shown above include code "SS" for AISI 440C stainless steel. If SAE 52100 chrome alloy steel is desired, delete "SS."
  - See page 63 for ABEC tolerances.
  - r=Maximum shaft or housing fillet radius that bearing corners will clear.
  - Open bearings may or may not have shield grooves (detail not shown in the above drawings). Consult the factory for reference information regarding the shield recess diameter.
- \* "R" Ribbon or "H" Crown cages are available as indicated. Please consult with factory for machined cage availability unless already noted.
  - ∅ Metric dimensions are for reference only.
  - ▲ Available only as flanged type.
  - \*\* Load ratings are based on ABMA Standard #12.