

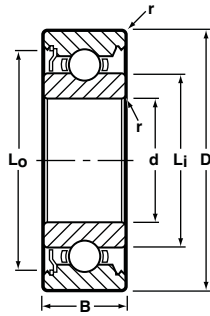

Radial, Shielded, Unflanged and Flanged



Unflanged
Shielded
Ribbon Cage



Flanged
Shielded
Ribbon Cage

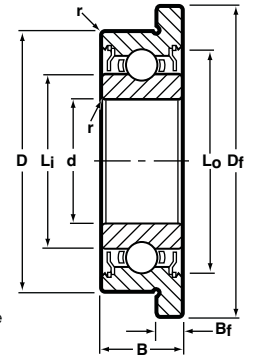

BASIC P/N †	CAGE OPTION	BORE d		O.D. D		WIDTH B		FLANGE DIA. D _f	FLANGE WIDTH B _f	LAND DIAMETER (REFERENCE)		FILLET RADIUS r		BALL COMPLEMENT		LOAD RATINGS**	
		mm	(INCH)◇	mm	(INCH)◇	mm	(INCH)◇			L _i	L _o	mm	(INCH)◇	NO. Z	SIZE D _b	Dyn. C	STATIC C ₀
SSR-515		1.5	.0591	5.0	.1969	2.6	.1024	6.5	0.8	2.60	4.00	.15	.0060	7	0.8mm	20	7
SSR-515Y52		1.5	.0591	5.0	.1969	2.5	.0984	—	—	2.60	4.00	.15	.0060	7	0.8mm	20	7
SSR-615		1.5	.0591	6.0	.2362	3.0	.1181	7.5	0.8	2.90	5.00	.15	.0060	6	3/64	35	11
SSR-620		2.0	.0787	6.0	.2362	3.0	.1181	7.5	0.8	3.10	5.20	.15	.0060	6	3/64	35	13
SSRFW-620 ▲		2.0	.0787	6.0	.2362	3.0	.1181	7.2	0.6	3.10	5.20	.15	.0060	6	3/64	35	13
SSR-620Y52		2.0	.0787	6.0	.2362	2.5	.0984	7.2	0.6	3.10	5.20	.15	.0060	6	3/64	35	13
☆ SSR-620Y32	H	2.0	.0787	6.0	.2362	2.3	.0906	—	—	3.16	5.20	.15	.0060	7	1.0mm	29	11
SSR-720Y03		2.0	.0787	7.0	.2756	3.0	.1181	8.2	0.6	3.80	5.90	.15	.0060	7	3/64	40	15
SSR-720		2.0	.0787	7.0	.2756	3.5	.1378	8.5	0.9	3.80	5.90	.15	.0060	7	3/64	40	15
SSR-725Y03		2.5	.0984	7.0	.2756	3.0	.1181	8.2	0.6	3.80	5.90	.15	.0060	7	3/64	40	15
SSR-725		2.5	.0984	7.0	.2756	3.5	.1378	8.5	0.9	3.80	5.90	.15	.0060	7	3/64	40	15
SSR-825		2.5	.0984	8.0	.3150	4.0	.1575	9.5	0.9	4.10	7.16	.15	.0060	6	1/16	60	22
SSRFW-825 ▲		2.5	.0984	8.0	.3150	4.0	.1575	9.6	0.8	4.10	7.16	.15	.0060	6	1/16	60	22
☆ SSR-830X	H/M5	3.0	.1181	8.0	.3150	4.0	.1575	9.5	0.9	4.39	7.21	.15	.0060	6	1/16	60	22
SSR-830Y03		3.0	.1181	8.0	.3150	3.0	.1181	—	—	4.77	6.85	.15	.0060	8	3/64	44	18
SSRFW-830 ▲		3.0	.1181	8.0	.3150	4.0	.1575	9.6	0.8	4.10	7.16	.15	.0060	6	1/16	60	22
SSR-930Y04		3.0	.1181	9.0	.3543	4.0	.1575	10.6	0.8	4.80	7.60	.15	.0060	7	1/16	66	26
SSR-930		3.0	.1181	9.0	.3543	5.0	.1969	10.5	1.0	4.80	7.60	.15	.0060	7	1/16	66	26
☆ SSR-1030	KC/M5/R	3.0	.1181	10.0	.3937	4.0	.1575	11.5	1.0	5.08	8.20	.15	.0060	7	1/16	66	26
SSRFW-1030 ▲		3.0	.1181	10.0	.3937	4.0	.1575	11.6	0.8	5.08	8.20	.15	.0060	7	1/16	66	26
SSR-1140		4.0	.1575	11.0	.4331	4.0	.1575	12.5	1.0	6.40	9.50	.20	.0080	8	1/16	75	31
SSRFW-1140 ▲		4.0	.1575	11.0	.4331	4.0	.1575	12.6	0.8	6.40	9.50	.20	.0080	8	1/16	75	31
☆ SSR-1140X	R	4.0	.1575	11.0	.4331	4.0	.1575	—	—	5.97	8.75	.30	.0120	8	1/16	75	31
SSR-1240		4.0	.1575	12.0	.4724	4.0	.1575	13.5	1.0	6.50	9.95	.20	.0080	7	2.0mm	104	42
SSR-1340		4.0	.1575	13.0	.5118	5.0	.1969	15.0	1.0	7.00	11.00	.20	.0080	7	3/32	139	60
☆ SSR-1640X	R	4.0	.1575	16.0	.6299	5.0	.1969	18.0	1.0	8.10	13.20	.30	.0120	8	3/32	157	68
SSR-1350WO5		5.0	.1969	13.0	.5118	5.0	.1969	15.0	1.0	7.50	11.10	.20	.0080	7	3/32	139	60
☆ SSR-1350	R	5.0	.1969	13.0	.5118	4.0	.1575	15.0	1.0	7.50	11.10	.20	.0080	8	2.0mm	112	49
SSR-1450		5.0	.1969	14.0	.5512	5.0	.1969	16.0	1.0	6.95	12.10	.20	.0080	7	3/32	139	60
☆ SSR-1650X	R	5.0	.1969	16.0	.6299	5.0	.1969	18.0	1.0	8.10	13.20	.30	.0120	8	3/32	157	68
☆ SSR-1950	R	5.0	.1969	19.0	.7480	6.0	.2362	22.0	1.5	8.74	16.22	.30	.0120	6	5/32	481	240
SSR-1560		6.0	.2362	15.0	.5906	5.0	.1969	17.0	1.2	7.76	13.20	.15	.0060	7	7/64	212	101
SSRFW-1560 ▲		6.0	.2362	15.0	.5906	5.0	.1969	17.0	1.0	7.76	13.20	.15	.0060	7	7/64	212	101
SSR-1760		6.0	.2362	17.0	.6693	6.0	.2362	19.0	1.2	8.22	14.77	.20	.0080	6	3.5mm	384	187
☆ SSR-1960	KC/M5/R	6.0	.2362	19.0	.7480	6.0	.2362	22.0	1.5	8.74	16.22	.30	.0120	6	5/32	481	226
☆ SSR-1970	R	7.0	.2756	19.0	.7480	6.0	.2362	22.0	1.5	10.60	15.90	.30	.0120	7	1/8	379	174
☆ SSR-2270	KC/R	7.0	.2756	22.0	.8661	7.0	.2756	25.0	1.5	10.76	18.90	.30	.0120	7	5/32	569	273
☆ SSR-1980X	R	8.0	.3150	19.0	.7480	6.0	.2362	22.0	1.5	10.60	15.90	.30	.0120	7	1/8	379	174
☆ SSR-2280	KC/M5/R	8.0	.3150	22.0	.8661	7.0	.2756	25.0	1.5	10.76	18.90	.30	.0120	7	5/32	569	273
SSR-2690		9.0	.3543	26.0	1.0236	8.0	.3150	—	—	13.80	22.66	.30	.0120	7	3/16	703	399

☆ Production standard.

Notes:

- Metric to inch conversion—see page 63.
- Basic part numbers shown above include code "SS" for AISI 440C stainless steel. If SAE 52100 chrome alloy steel is desired delete SS.
- See page 61 for ABEC tolerances.
- r=Maximum shaft or housing fillet radius that bearing corners will clear.
- Please consult with factory for cage availability.
- While we have the capability to produce the sizes listed, they are not all currently in production. Please consult with factory for minimum order quantity and quote.
- Add "Z" for single shield, "ZZ" for two shields as a suffix to basic part number prior to "Y" or "W" width variations.
- † For flanged bearing substitute prefix SSRF- when applicable.
- ▲ Available only as flanged type.
- ◇ Inch conversions are given for reference only.
- ** Load ratings are based on ABMA Standard #12.