

Radial, Open, Unflanged

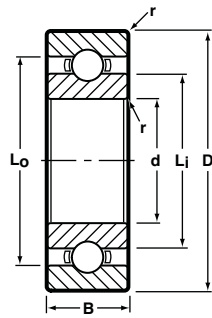

Ribbon Cage



Crown Cage

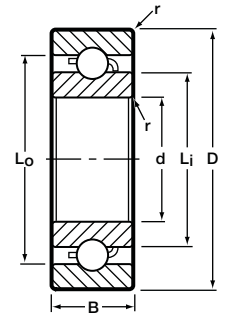

| BASIC P/N   | STANDARD CAGE AVAILABILITY* |       | BORE d |        | O.D. D |        | WIDTH B |       | LAND DIAMETER (REFERENCE) |       | FILLET RADIUS r | BALL COMPLEMENT |         | LOAD RATINGS** LBS. |           | BRG. WGT. GMS. ▼ |
|-------------|-----------------------------|-------|--------|--------|--------|--------|---------|-------|---------------------------|-------|-----------------|-----------------|---------|---------------------|-----------|------------------|
|             | RIBBON                      | CROWN | INCH   | (mm)◇  | INCH   | (mm)◇  | INCH    | (mm)◇ | Li                        | Lo    |                 | NO. Z           | SIZE Db | DYN. C              | STATIC Co |                  |
| SSRI-2      |                             | H     | .0400  | 1.016  | .1250  | 3.175  | .0469   | 1.191 | .064                      | .100  | .003            | 5               | .025    | 9                   | 3         | .05              |
| SSRI-2 1/2  |                             | H     | .0469  | 1.191  | .1562  | 3.967  | .0625   | 1.588 | .081                      | .124  | .003            | 6               | 1/32    | 16                  | 5         | .15              |
| SSRI-3      |                             | H     | .0550  | 1.397  | .1875  | 4.763  | .0781   | 1.984 | .093                      | .159  | .003            | 5               | 3/64    | 28                  | 10        | .20              |
| SSRI-4      |                             | H     | .0781  | 1.984  | .2500  | 6.350  | .0937   | 2.380 | .122                      | .193  | .003            | 6               | 3/64    | 35                  | 12        | .50              |
| SSRI-3332   |                             | H     | .0937  | 2.380  | .1875  | 4.763  | .0625   | 1.588 | .118                      | .161  | .003            | 7               | 1/32    | 19                  | 6         | .10              |
| SSRI-3332   | R                           |       | .0937  | 2.380  | .1875  | 4.763  | .0625   | 1.588 | .118                      | .161  | .003            | 8               | 1/32    | 21                  | 8         | .10              |
| SSRI-5      | R                           | H     | .0937  | 2.380  | .3125  | 7.938  | .1094   | 2.779 | .173                      | .270  | .003            | 6               | 1/16    | 60                  | 22        | .85              |
| SSRI-418    |                             | H     | .1250  | 3.175  | .2500  | 6.350  | .0937   | 2.380 | .161                      | .216  | .003            | 7               | .0394   | 30                  | 11        | .35              |
| SSRI-418    | R                           |       | .1250  | 3.175  | .2500  | 6.350  | .0937   | 2.380 | .161                      | .216  | .003            | 8               | .0394   | 33                  | 12        | .35              |
| SSRI-518    | R                           | H     | .1250  | 3.175  | .3125  | 7.938  | .1094   | 2.779 | .173                      | .270  | .003            | 6               | 1/16    | 60                  | 22        | .70              |
| SSRI-618    | R                           | H     | .1250  | 3.175  | .3750  | 9.525  | .1094   | 2.779 | .173                      | .270  | .005            | 6               | 1/16    | 60                  | 22        | 1.30             |
| SSR-2       | R                           | H     | .1250  | 3.175  | .3750  | 9.525  | .1562   | 3.967 | .200                      | .300  | .012            | 7               | 1/16    | 66                  | 26        | 1.30             |
| SSR-2A      | R                           | H     | .1250  | 3.175  | .5000  | 12.700 | .1719   | 4.366 | .200                      | .300  | .012            | 7               | 1/16    | 66                  | 26        | 3.10             |
| SSRI-5532   |                             | H     | .1562  | 3.967  | .3125  | 7.938  | .1094   | 2.779 | .221                      | .279  | .003            | 7               | 3/64    | 41                  | 15        | .65              |
| SSRI-5532   | R                           |       | .1562  | 3.967  | .3125  | 7.938  | .1094   | 2.779 | .221                      | .279  | .003            | 8               | 3/64    | 45                  | 17        | .65              |
| SSRI-5632   |                             | H     | .1875  | 4.763  | .3125  | 7.938  | .1094   | 2.779 | .221                      | .279  | .003            | 7               | 3/64    | 41                  | 15        | .50              |
| SSRI-5632   | R                           |       | .1875  | 4.763  | .3125  | 7.938  | .1094   | 2.779 | .221                      | .279  | .003            | 8               | 3/64    | 45                  | 17        | .50              |
| SSRI-6632   | R                           | H     | .1875  | 4.763  | .3750  | 9.525  | .1250   | 3.175 | .235                      | .325  | .003            | 8               | 1/16    | 76                  | 31        | .90              |
| SSR-3       | R                           | H     | .1875  | 4.763  | .5000  | 12.700 | .1562   | 3.967 | .276                      | .413  | .012            | 7               | 3/32    | 140                 | 59        | 2.60             |
| SSRI-614    |                             | H     | .2500  | 6.350  | .3750  | 9.525  | .1250   | 3.175 | .285                      | .341  | .003            | 13              | .0394   | 43                  | 21        | .65              |
| SSRI-814    | R                           | H     | .2500  | 6.350  | .5000  | 12.700 | .1250   | 3.175 | .330                      | .431  | .005            | 10              | 1/16    | 88                  | 40        | 1.90             |
| SSR-4       | R                           | H     | .2500  | 6.350  | .6250  | 15.875 | .1960   | 4.978 | .364                      | .510  | .012            | 8               | 3/32    | 159                 | 70        | 4.40             |
| SSRI-1214   | R                           |       | .2500  | 6.350  | .7500  | 19.050 | .2188   | 5.558 | .386                      | .597  | .016            | 6               | 9/64    | 412                 | 193       | 8.70             |
| SSRI-8516   | R                           |       | .3125  | 7.938  | .5000  | 12.700 | .1562   | 3.967 | .362                      | .450  | .005            | 11              | 1/16    | 93                  | 43        | 1.60             |
| SSRI-1038   | R                           |       | .3750  | 9.525  | .6250  | 15.875 | .1562   | 3.967 | .457                      | .542  | .010            | 12              | 1/16    | 96                  | 53        | 2.60             |
| SSRI-1438   | R                           |       | .3750  | 9.525  | .8750  | 22.225 | .2188   | 5.558 | .521                      | .741  | .016            | 7               | 5/32    | 569                 | 273       | 8.80             |
| SSRI-1412   | R                           |       | .5000  | 12.700 | .8750  | 22.225 | .2188   | 5.558 | .622                      | .752  | .016            | 12              | 3/32    | 198                 | 110       | 9.18             |
| SSRI-1812   | R                           |       | .5000  | 12.700 | 1.1250 | 28.575 | .2500   | 6.350 | .701                      | .913  | .016            | 9               | 5/32    | 684                 | 344       | 22.00            |
| SSRI-2258   | R                           |       | .6250  | 15.875 | 1.3750 | 34.925 | .2812   | 7.142 | .868                      | 1.132 | .031            | 8               | 7/32    | 1500                | 740       | 32.00            |
| SSRI-2634 ♦ |                             |       | .7500  | 19.050 | 1.6250 | 41.275 | .3125   | 7.938 | 1.037                     | 1.338 | .031            | 8               | 1/4     | 1900                | 980       | 43.00            |
| SSRI-3078 ♦ |                             |       | .8750  | 22.225 | 1.8750 | 47.625 | .3750   | 9.525 | 1.225                     | 1.526 | .031            | 10              | 1/4     | 2200                | 1300      | 95.00            |

Notes:

- Inch to metric conversion—see page 63.
- Basic part numbers shown above include code "SS" for AISI 440C stainless steel. If SAE 52100 chrome alloy steel is desired delete SS.
- See page 61 for ABEC tolerances.
- r=Maximum shaft or housing fillet radius that bearing corners will clear.

- \* "R" Ribbon or "H" Crown cages are available as indicated. Please consult with factory for machined cage availability.
- ◇ Metric dimensions are for reference only.
- \*\* Load ratings are based on ABMA Standard #12.
- ♦ Limited retainer options available. Please consult with factory.
- ▼ Bearing weights are for reference only.