

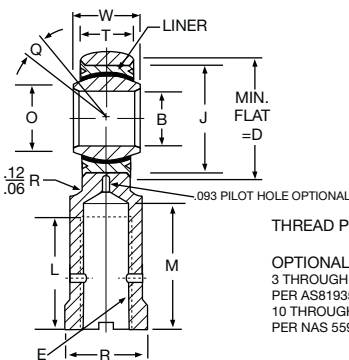

AS81935 Wide – Female Thread

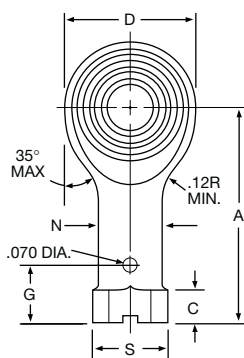

Notes:

- Bearings listed in the tables are approved for procurement to AS81935.
- Temperature: Operating temperature range per AS81935; -65° to 325°F. Broader temperature capabilities are achievable.

THREAD PER AS8879

OPTIONAL KEYSLOT:
3 THROUGH 8 SIZES
PER AS81935/2
10 THROUGH 16 SIZES
PER NAS 559 OR NAS 513

Part Number	MS Dash No.	(B) Bore Diameter	(D) Head Diameter	(W) Ball Width	(T) Body Width	(O) Shoulder Diameter	Ball Diameter	(A) Ball C/L to End	(E) Thread Size	(L) Complete Thread	(N) Shank Diameter	(M) Drill Depth	(C) Flange Thickness	(R) Wrench Flat	(S) Corners or Diam.	(G) Drill C/L to End	(J) Housing I.D.	(Q) Mis-alignment
		Inch	Inch	Inch	Inch	Inch	Inch	Inch		Inch	Inch	Inch	Inch	Inch	Inch	Inch	Inch	Ref.
M81935/2*		+ .0000 - .0005	+ .010 - .010	+ .000 - .002	+ .005 - .005	Min.	Ref.	+ .010 - .010	UNJF-3B	Min.	+ .010 - .010	Max.	+ .010 - .062	+ .002 - .010	Ref.	+ .020 - .020	Max.	
ADN3J	-3	.1900	.806	.437	.337	.300	.531	1.375	5/16-24	.750	.422	.875	.188	.437	.500	.375	.6250	15°
ADN4J	-4	.2500	.806	.437	.337	.300	.531	1.469	5/16-24	.750	.422	.875	.188	.437	.500	.375	.6250	15°
ADN5J	-5	.3125	.900	.437	.327	.360	.593	1.625	3/8-24	.875	.485	1.000	.250	.500	.580	.437	.6875	14°
ADN6J	-6	.3750	1.025	.500	.416	.470	.687	1.812	3/8-24	1.000	.547	1.125	.250	.562	.660	.437	.8125	8°
ADN7J	-7	.4375	1.150	.562	.452	.540	.781	2.000	7/16-20	1.125	.610	1.250	.250	.625	.720	.500	.9062	10°
ADN8J	-8	.5000	1.337	.625	.515	.610	.875	2.250	1/2-20	1.250	.735	1.375	.250	.750	.880	.562	1.0000	9°
ADN10J	-10	.6250	1.525	.750	.577	.750	1.062	2.500	5/8-18	1.375	.860	1.500	.375	.875	1.020	.687	1.1875	12°
ADN12J	-12	.7500	1.775	.875	.640	.850	1.250	2.875	3/4-16	1.625	.985	1.750	.375	1.000	1.160	.812	1.3750	13°
ADN14J	-14	.8750	2.025	.875	.765	1.000	1.375	3.375	7/8-14	1.875	1.110	2.062	.500	1.125	1.300	.937	1.6250	6°
ADN16J	-16	1.0000	2.775	1.375	1.015	1.270	1.875	4.125	1 1/4-12	2.125	1.688	2.312	.563	1.750	2.020	1.312	2.1250	12°

* For rod ends with threads per MIL-S-7742 Rev. D (UNF-3B), omit "J" from part number.

Aerospace Standard P/N - Wide

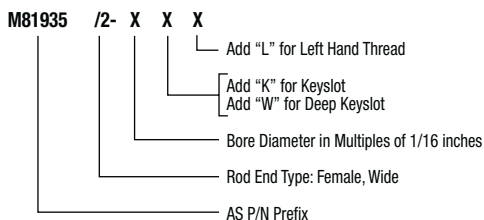

NHBB P/N - Wide

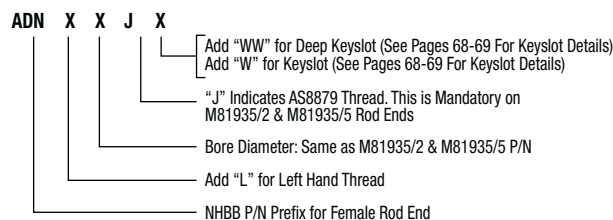

Materials

Part No.	Ball	Race	Liner	Body
Catalog No.	CRES 440C AMS 5630 Rc55-62	CRES 17-4PH AMS 5643 Rc28-37	TEFLON®/Fabric Bonded to Race I.D. No Lub. Required	4340 Alloy Steel, AMS6415 Rc39-42 Cadmium Plated††
Catalog No. + CR†	CRES 440C AMS 5630 Rc55-62	CRES 17-4PH AMS 5643 Rc28-37	TEFLON®/Fabric Bonded to Race I.D. No Lub. Required	CRES 17-4PH AMS 5643 Rc39-44 Passivated

†† Body Cadmium plated per AMS-QQ-P-416, Type II, CL. 2 on all surfaces including body bore.

† Stainless Steel Series is not available to Aerospace Standard, but may be ordered to NHBB Part Number as indicated. Example: ADN4CRJ or ADN 4-345CR

TEFLON® is a Du Pont registered trademark

Performance Properties – Wide

MS Dash No.	No Load Rotational Breakaway Torque	Ultimate Static Radial Load	Axial Static Proof Load	Fatigue Load	Approx. Weight	
						In-lbs.
M81935/2*						
ADN 3J	-3	.5-6	2360	1000	1470	.080
ADN 4J	-4	.5-6	4860	1000	2380	.084
ADN 5J	-5	1-15	7180	1100	3020	.102
ADN 6J	-6	1-15	8550	1660	3570	.161
ADN 7J	-7	1-15	12000	1850	4800	.212
ADN 8J	-8	1-15	19500	2040	8260	.325
ADN 10J	-10	1-15	21900	2430	9180	.481
ADN 12J	-12	1-15	29300	2810	11600	.673
ADN 14J	-14	1-24	34500	3320	13100	.959
ADN 16J	-16	1-24	80300	4340	30400	2.717

* For rod ends with threads per MIL-S-7742 Rev. D (UNF-3B), omit "J" from part number